



# JOLLYFILL

## Bottom inlet valve



### Stage 1 : PRE-INSTALLATION

- ❶ Turn off water supply to cistern and remove cistern lid.
- ❷ Flush the cistern and remove any loose dirt from inside the tank.
- ❸ Disconnect and remove existing filling valve

### Stage 2 : FITTING YOUR FILLING VALVE

- ❶ Insert correct filter restrictor into threaded tail.

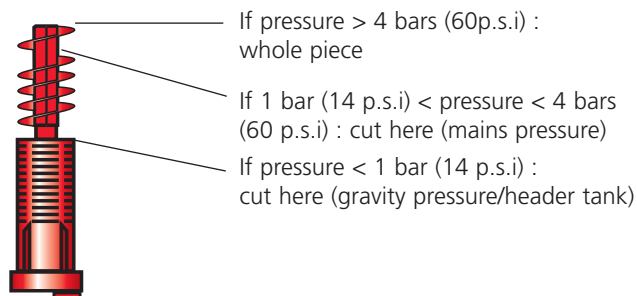

ref.A11007

02/08



**WIRQUIN plastiques** 11 rue du Château de Bel Air  
44 482 CARQUEFOU CEDEX - FRANCE  
www.wirquin.com  
Tél. consommateur Export : (33) 02 40 30 68 00

- ❷ Fit the filling valve. Ensure that the valve does not obstruct the flush mechanism. Do not overtighten the back nut.

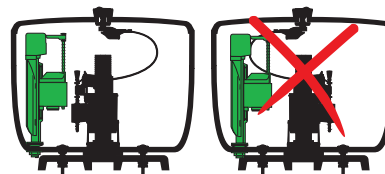

3 Important for new build / installations : before turning water on, ensure that one cold water tap is open so that dirt and loose particles in the pipe work are flushed through the tap (we also recommend to flush through the water supply pipe to the cistern)

4 Connect water supply.

5 Turn on water supply. Allow the cistern to fill. Adjust the water level :

- A Flush the cistern and turn off water supply
- B Unclip the adjustment rod from the float (5B)
- C Adjust the height of the float basin on the body (5C)
- D Clip the adjustment rod on the float (5D) : check that the red arm is in low position before clipping the rod and the float is positioned inside the float basin.
- E Check the water level is right
- F Check that the high level of the float basin is lower than the top level of the flushing valve overflow.

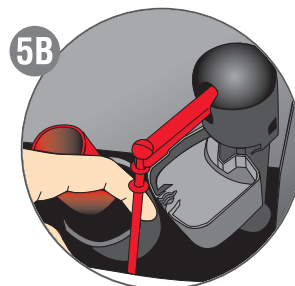
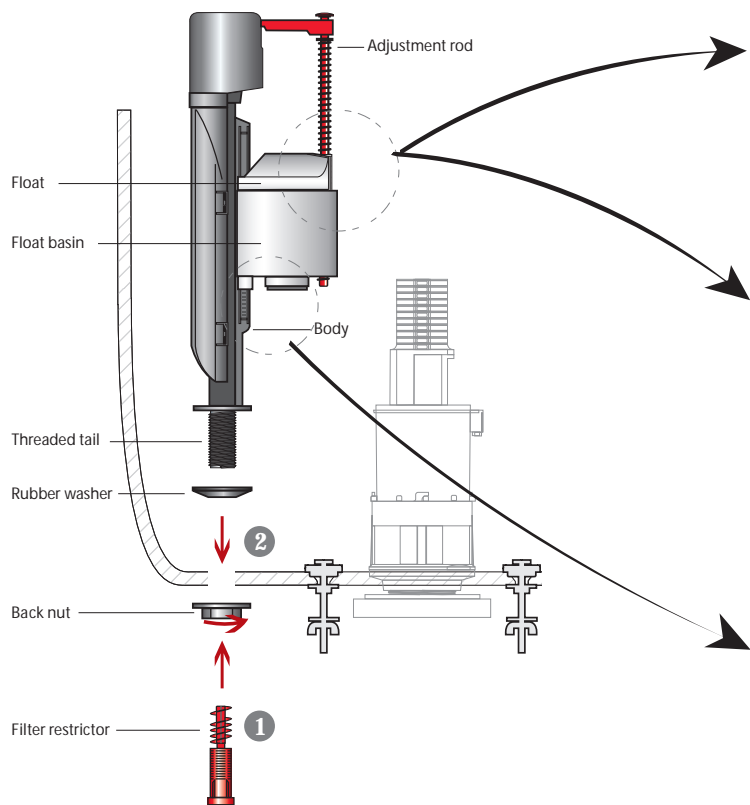
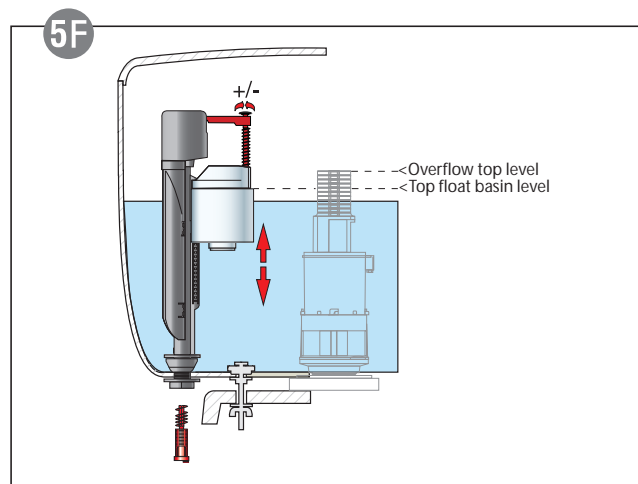

LOW POSITION  
**OK**

HIGH POSITION  
**NOT OK**

